

● Mounting size

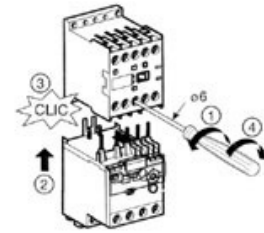

● Wiring Diagram

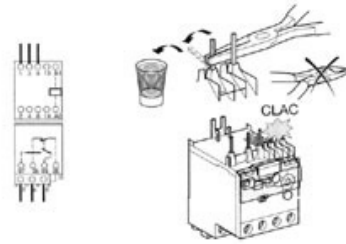

⚠ Hazardous voltage

Philips N° 2						φ 6				
[mm <sup>2</sup> ]	[mm <sup>2</sup> ]	[mm <sup>2</sup> ]	[mm <sup>2</sup> ]	[mm <sup>2</sup> ]	[mm <sup>2</sup> ]	[mm]	C [Nm]	L [mm]	φ [mm]	
0,34	0,34...2,5	0,75	0,75...4	1,5	1,5...4	7	0,8	7	3	
·	+	·	+	·	+					
2,5	0,34...1,5	4	0,75...4	4	1,5...4					

扭矩(Torque): 7 lb.in      AWG: 1 × 18min.  
2 × 14 or 1 × 12max.

● Utilisation of the special Functions

Setting the relay ▶

Stop function ▶

Manual reset/Rearmement manuel ▶

Wiring Diagram/Schema de branchement ▶

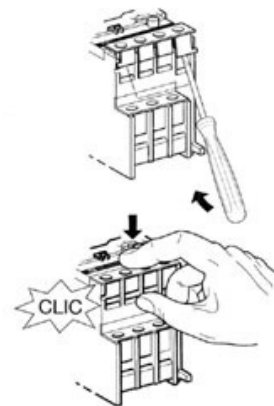

● Wiring Diagram

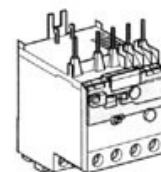
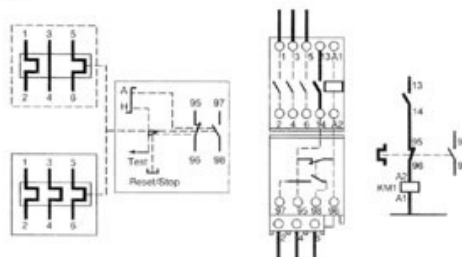

除了低能耗触点以外  
Except low consumption contactors